



2017 SPEAK FOUNDATION CONFERENCE
Westin Buckhead Atlanta
Friday, July 7th - Sunday, July 9th

Itinerary and Schedule of Events

Friday, July 7

4:00-5:30pm Group Dinner (Optional)- TBD

- Those interested in a group dinner can gather at a place TBD within walking/wheelchair distance to the hotel. This meal is not covered by the conference.

5:30-6:00pm Conference Registration/Check-In- Woodruff Rm (lobby level)

- Please check-in promptly at the table just inside of the conference room on your way into our official conference opening and Session One. *Please note that \$20.00 will be required at check in for each guest beyond attendee +1 for Saturday's dinner. We appreciate you being checked in and seated by 6:00pm!

6:00-6:15pm Conference Welcome- Woodruff Rm

- Introduction, brief schedule announcement, housekeeping items, etc.

6:15-7:30pm Session One: Panel Discussion- Woodruff Rm

Patient Education & Engaging Patients in Healthcare: Pathways to Treatments

- Kathryn Bryant, MAMFC, MCE, National Director, Speak Foundation- *Emerging Biotechnology & Patient Groups: Importance of Both*
- Brad Williams, PhD, The Jain Foundation- *Muscular Dystrophy & Subtype Discoveries*
- Vovanti Jones, MD, Physiatrist living with LGMD2B- *Perspectives on Being a Patient & Physician*

7:30-7:45pm BREAK

7:45-8:45pm Session Two: Physical Therapist's Role in Muscular Dystrophy- Woodruff Rm

- Christine A. Cronin, PT, DPT, PCS, MBA, MS & Keenan Whitesides, PT, DPT will be speaking on Physical Therapist's Role in Muscular Dystrophy. Christine is the Associate Professor/Director of Newark Therapy Services Faculty Practice at Rutgers School of Health Professionals. Keenan is currently employed as a Neurological Physical Therapist in the Neuro Rehab Clinic of Emory University.

8:45-9:00pm "Wrap Up"- Woodruff Rm

- Discussion of next day's agenda and sign-ups for Sunday/Funday

9:00pm Informal Social Time- Westin Hotel

All events are subject to change. Also, please let us know if you have any questions or concerns!

Saturday, July 8

Breakfast on your own

10:30-11:00am **Late Registration/Check-In-** Woodruff Rm

- For attendees who were not able to check-in/attend Friday evening, please check-in at the table inside of the conference room on your way into Session Three.

11:00am-1:15pm **Session Three: Shepherd Center's Adapted Driving Services**

- 11:00am- 12:00pm **Adapted Driving Equipment & Process-** Woodruff Rm
The Shepherd Center's Jim Kennedy, CDRS & Dan Allison Jr. MS, OTR/L, ATP, CDRS will present for us.
- 12:00-1:15pm **Shepherd Center Van Tours-** Westin hotel valet area (located on side of hotel). You will have the option to view some adapted vans at the hotel. MobilityWorks is also sponsoring a table.

1:15-2:00pm **Group Lunch-** Woodruff Rm

- This meal is being donated by Chick-Fil-A and the Westin hotel.

2:00-3:00pm **Session Four: Attendee and Caregiver Support Session-** Woodruff Rm

- Caregivers, aids, family members, and significant others/spouses of those with a NMD will stay together to discuss issues related to caregiving as a group. We will have a separate area for those of us with a NMD to share experiences on topics such as coping and adaptive strategies, physical and emotional challenges, etc. (option- break into male/female groups)
- If you have physical needs that would make it difficult to be apart from a caregiver during this time, please let us know and we will work on a solution with you that best suits your needs.

3:00-3:15pm **BREAK**

3:15-4:15pm **Session Five: Using the Crown & Sash to Advocate/Millennium Respiratory-** Woodruff Rm

- Ms. Wheelchair Tennessee 2017, Andrea Lewis Klein, lives with Collagen 6 Congenital Muscular Dystrophy and has dedicated her time to starting and running the nonprofit "Breathe with MD" to educate and disseminate information on respiratory decline in neuromuscular diseases. Andrea will be speaking on advocacy.
- Millennium Respiratory Services will be on hand to provide a patient demonstration, answer breathing related questions, and provide information. Millennium RT's are trained in neuromuscular-related breathing issues and understand the specific issues relevant to this population.

4:15-4:45pm **Mini-Session: Skype Presentation with Dr. Robert Leshner ("Physician of the Year Award")**

- Dr. Robert Leshner spent the majority of his professional life treating pediatric patients as a neurologist in Virginia and changed countless lives with his determination to diagnosis properly, find emerging treatments, and prevent complications from a progressive disease. Dr. Leshner is renowned and acclaimed for his contributions in the field of treatments for muscular dystrophy. He will also be available to answer neurological concerns with time permitting via Skype.

4:45-5:15pm **Session Six: Caregiving from the Perspective of a Spouse with Spring Reed-** Woodruff Rm

- Spring Reed is the wife of the late Charles Reed who lived with Duchenne MD. She is a Founder/Speaker for Charles and Spring Ministries, developed in partnership with Charles. Spring will be speaking on issues of caregiving and also sharing Charles' message of hope for those with NMDs.

All events are subject to change. Also, please let us know if you have any questions or concerns!

5:15-6:30pm **BREAK**

- Get ready for dinner (optional- meet early in Dantanna's patio area before dinner)

6:30-8:30pm **Group Dinner-** Dantanna's Surf & Turf in Buckhead

- This meal is covered by TSF for the attendee + 1 guest. Cost is \$20.00 per each additional guest you bring (due at registration). Dantanna's is an upscale restaurant conveniently located right behind our hotel, a short walk down the sidewalk.
- Presentation of our annual "Ette Ndem Christian Humanitarian Award"

8:30pm **Informal Social Time-** Westin Hotel

Sunday, July 9

12:00-1:30pm **Lunch (Optional)-** TBD

- Those interested can arrange to have a group lunch together at a place TBD within walking/wheelchair distance to the hotel. This meal is not covered by the conference.

1:30-4:00pm **Group Outing (Optional)-** TBD (we will visit area attractions per attendees requests)

- MARTA is fully accessible for someone using a wheelchair or scooter. The Concierge Desk has information about area attractions available to you. Some of Atlanta's popular attractions include shopping at Lenox Square Mall, Shops Around Lenox, or Phipps Plaza, as well as the Georgia Aquarium, World of Coca-Cola, CNN Studio Tours, Zoo Atlanta, Center for Civil and Human Rights, Fernbank Museum of Natural History, College Football Hall of Fame, Legoland Discovery Center, Stone Mountain Theme Park, and more. If you plan to explore Atlanta, read more about the city pass at http://www.citypass.com/atlanta?mv_source=wocc. It enables you to visit multiple must-see Atlanta attractions for one fee!

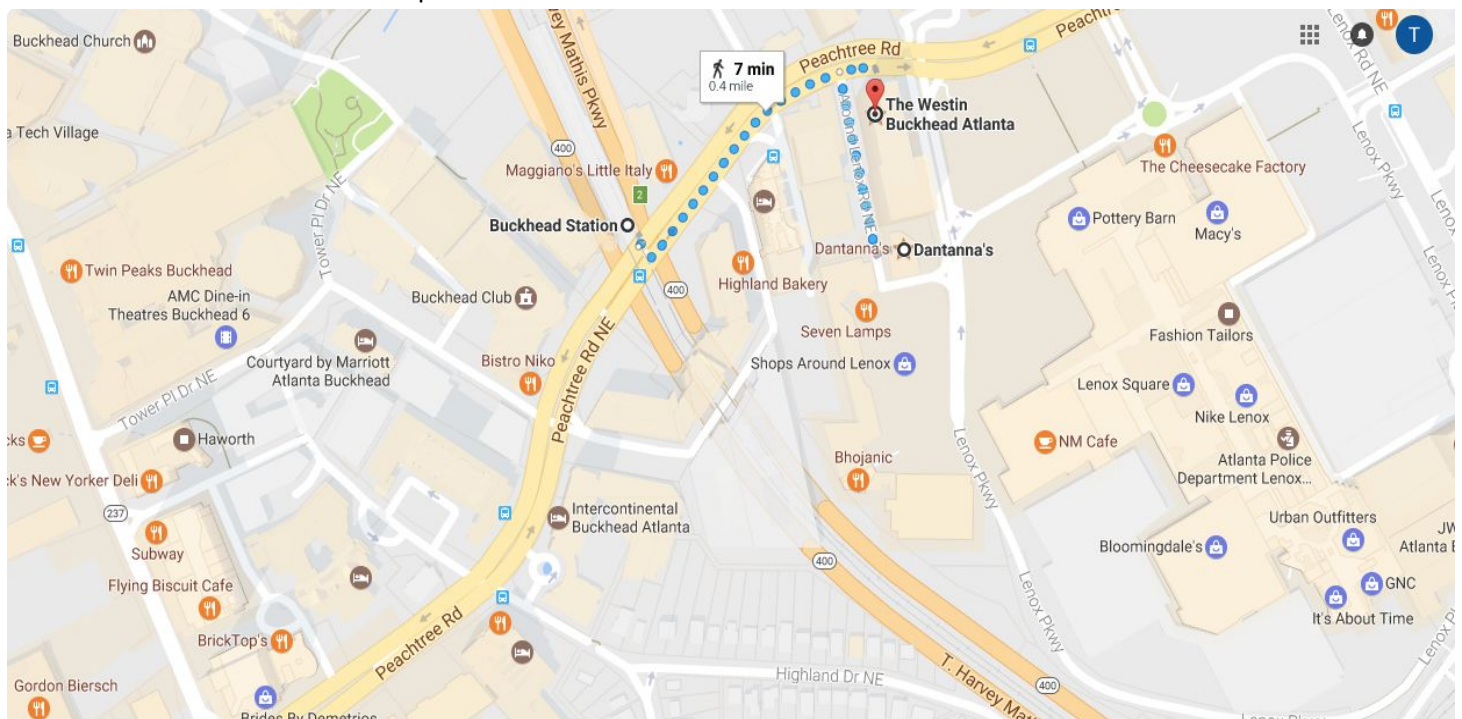

All events are subject to change. Also, please let us know if you have any questions or concerns!

Westin Hotel- Woodruff Conference Room

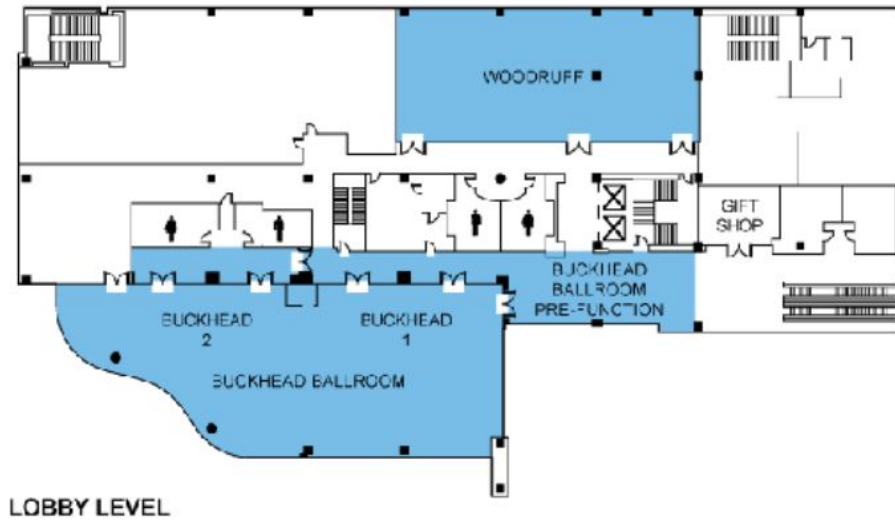

All events are subject to change. Also, please let us know if you have any questions or concerns!